

# TECHNICAL PARAMETER TABLE

ITEM	SPECIFICATION	HTW68		
		A	B	C
<b>INJECTION UNIT</b>				
SCREW DIAMETER	mm	26	30	32
SCREW L/D RATIO	L/D	25.4	22	20.6
SHOT VOLUME(THEORETICAL)	cm <sup>3</sup>	67.6	90	102
INJECTION WEIGHT(PS)	g	61.4	82	93
INJECTION RATE	g/s	55	73	83
INJECTION PRESSURE	MPa	250	188	165
SCREW SPEED	rpm	195		
<b>CLAMPING UNIT</b>				
CLAMP FORCE	kN	680		
OPEN STROKE	mm	280		
SPACE BETWEEN TIE BARS(WxH)	mm	310x310		
MAX.MOULD HEIGHT	mm	320		
MIN.MOULD HEIGHT	mm	100		
EJECTOR STROKE	mm	80		
EJECTOR FORCE	kN	28		
<b>OTHERS</b>				
MAX.PUMP PRESSURE	MPa	16		
PUMP MOTOR POWER	kW	7.5		
HEATING POWER	kW	6.8		
MACHINE DIMENSION(LxWxH)	m	3.65x1.16x1.73		
OILTANK CUBAGE	L	170		
MACHINE WEIGHT	t	2.5		

Platen Dimensions

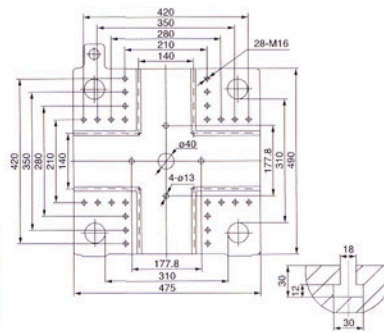

Platen Dimensions

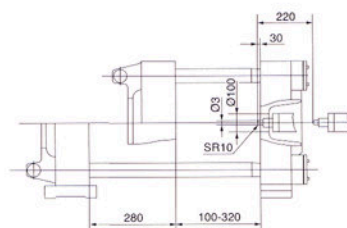

Floor Flan Layout

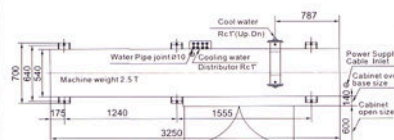

HTW1 10			HTW1 40		
A	B	C	A	B	C
32	35	38	38	42	45
24.1	22	20.2	22.1	20	18.6
137	163	192	193	235	270
125	148	175	176	213	246
74	89	105	94	115	132
260	219	186	205	170	147
	210			190	
	1100			1400	
	350			380	
	360x360			410x410	
	380			450	
	150			160	
	100			120	
	38			38	
	16			16	
	13			13	
	7.45			7.8	
	4.32x1.27x1.90			4.48x1.33x1.90	
	200			230	
	3.4			4.0	
